

Toyota 16 Factory Pin 6.1" Display Radio Camera Interface Harness (Kit # 9002-2630)

Please read thoroughly before starting installation and check that kit contents are complete.

Items Included in the Kit:

Interface Harness
6' Green Reverse Wire with Terminal (if Rec'd)
These Instructions

Tools & Supplies Needed:

Phillips Screw Driver
10mm Socket
Plastic Trim Removal Tool
Vehicle service manual (If needed)

Safety Precautions:

- Work in well ventilated area that is clear of obstructions.
- Secure vehicle with tire chucks in both front and rear of tires.
- Turn vehicle accessories OFF and ensure ignition key is in OFF position.
- Wear safety goggles and snug fitting clothes.
- Use tools only for their intended purpose and which are in good repair.
- Only perform this task if confidence, skill, and physical ability permit.

NOTE: We strive to provide accurate and up-to-date installation instructions. For the latest full color instructions, as well as an installation video, please visit www.brandmotion.com

Step 1: Use a plastic trim removal tool, 10mm socket, and Phillips screwdriver to remove garnish and fasteners securing the radio display.

Step 2: Remove the radio and disconnect the smaller white 16-pin connector.

Step 3: Plug the white 16-pin radio connector into the female end of supplied Jumper Harness.

Step 4: Plug the male 16-pin connector of supplied Jumper Harness into the radio.

Step 5: Connect Camera Harness male RCA connector to Display Interface Harness female RCA connector.

Step 6: Reinstall radio display and inspect that all connections are proper and secure.

Step 7: Test system. Next, start vehicle and shift into Reverse and check radio display for the camera image.



Step 8: Reverse Feed (If Req'd). In Scion and Tacoma vehicles you may need to supply the reverse signal to the radio. Use the loose green wire supplied in this kit. First insert the terminal end into pin-2 of the white 28-pin radio connector. See page two of these instructions for your vehicle reverse wiring location.

Step 9: Reassemble vehicle. Follow your disassembly steps in reverse order, taking care not to bind the harness wiring when reinstalling trim.

Scion FR-S

Connect loose Green reverse wire to Pink wire pin 5 in connector HD1. Located in driver's side foot well.

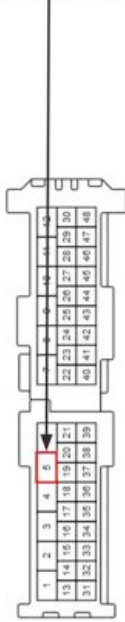

Toyota Tacoma

Connect loose Green reverse wire to Red wire pin 1 in Gray 12 pin connector. Located in driver's side foot well.

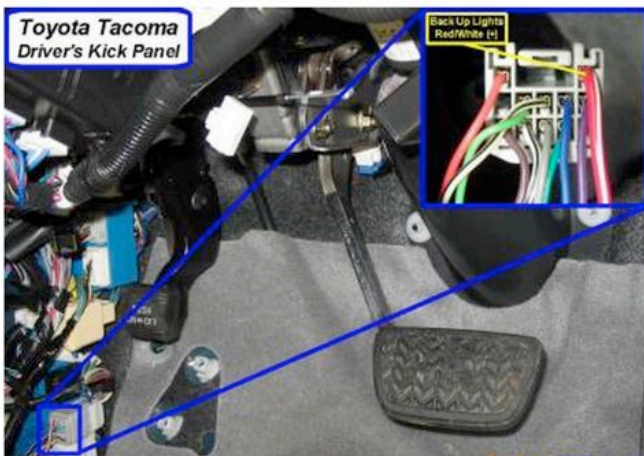

INSTALLATION INSTRUCTIONS

Scion XD

Connect loose Green reverse wire to Red wire pin 30 in connector 4A. Located in driver's side foot well.

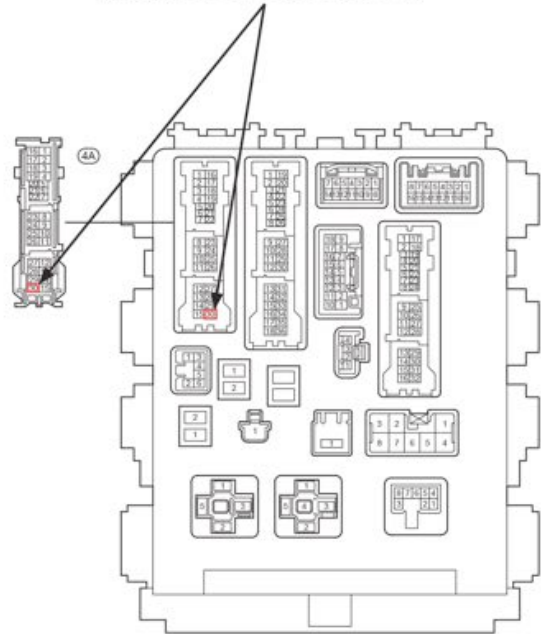

Scion XB

Connect loose Green reverse wire to Red wire pin 30 in connector 2A. Located in driver's side foot well.

