

**Backup Camera Interface for BMW with 8 preset buttons
w/ Dynamic Park Lines
(Kit # 9002-2773)**

Please read thoroughly before starting installation and check that kit contents are complete.

Items Included in the Kit:

9002-2773 module
Camera/power input T-harness
LVDS Video cable
IR eye
Remote
These instructions

Tools & Supplies Needed:

Wire strippers
Wire cutters
Electrical tape
Zip ties
Plastic panel removal tools
Screwdriver
Socket set
Wrench
Torx driver set

Safety Precautions:

- Work in well ventilated area that is clear of obstructions.
- Secure vehicle with tire chucks in both front and rear of tires.
- Turn vehicle accessories OFF and ensure ignition key is in OFF position.
- Wear safety goggles and snug fitting clothes.
- Use tools only for their intended purpose and which are in good repair.
- Only perform this task if confidence, skill, and physical ability permit.

NOTE: We strive to provide accurate and up-to-date installation instructions. For the latest full color instructions, as well as an installation video, please visit www.brandmotion.com

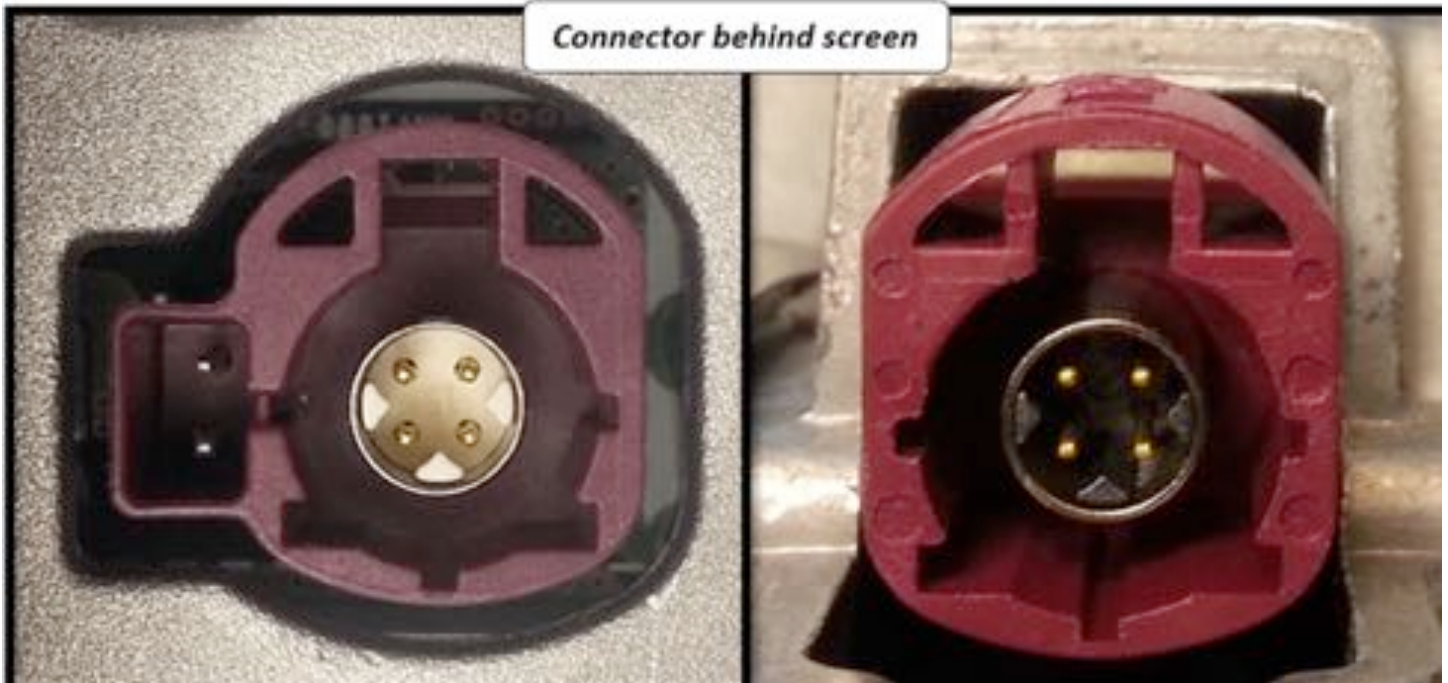

THIS CONNECTOR REQUIRES 9002-2773

THIS CONNECTOR REQUIRES 9002-2774

Dash Disassembly (5 series)

1. Remove the trim that surrounds the center vents and extends over the glove box with a plastic panel removal tool. There should be no screws holding this trim in.



2. Remove screws holding in the factory screen. Remove the plugs that are plugged into the screen.
3. Remove the trim to gain access to the I-Drive knob CAN connector by removing the trim ring around the center console release button and "pop" off. This will expose the screws mounting the center console trim.
4. Remove the screws and use a plastic trim removal tool to remove the center console trim.



5. Unplug the blue CAN connector to the I-Drive and plug into the 9002-2773 T-harness then plug the other end of the T-harness into the I-Drive where you just removed the CAN connector from.



6. Route the T-harness to the bottom of the radio opening.
7. Route the LVDS connector that was unplugged from the screen to the radio opening.
8. Connect the Blue plug end of the LCD video harness to the back of the screen and reconnect and other plugs that were disconnected from the screen.
9. Route the LCD video harness to the radio opening. Reinstall the screen.
10. Connect your camera RCA to the Yellow RCA on the Camera/Power T-harness labeled CAMERA.
11. Before plugging in the 9002-2773 module configure the dip switches as on the last page of these instructions.
12. Plug in Camera/Power input harness to the connector labeled POWER CAN.



13. Plug in the LVDS Video cable to the connector labeled LCD OUT.



14. Plug in the factory LVDS into the connector labeled LCD IN.



15. You can mount the 9002-2773 module to the bottom of the factory single DIN radio with double sided tape.

INSTALLATION INSTRUCTIONS

16. The IR eye and remote will not be used. The 9002-2773 has already been configured for use with a reverse camera. (The remote and eye will be used if adding a front camera. *See next page.*)
17. Check to see if the camera image is displayed on the factory screen. By placing the vehicle in reverse.
18. If image is not showing from the camera that the green reverse trigger wire might need to be connected to the +12 volt reverse wire.

- The IR-Eye must be connected
- Make sure the car's ignition is on and radio is on
- You must be in **Reverse Camera mode** **OR** **AUX Video** mode (see below):
 - **Reverse Camera Mode** adjusts Reverse Camera Settings
 - **AUX Video Mode** adjusts AUX Video Settings
- Press the **OK BUTTON** 4 times (numbers will display per press), then press **POWER**.
- The **OSD Menu** will appear on screen (auto-time out in about 5 seconds if no action occurs).



If adding a front camera OR Aux Video source:

1. Disconnect POWER/CAN Harness from interface
2. Place DIP SWITCH 1 in the DOWN position, reconnect power
3. Press and hold the iDRIVE knob 'MENU' to activate the AUX screen
4. Press **OK** button on remote 4 times, then press **POWER**

SET – FRON CAM must be turned on if adding a front camera **and** the user wishes for automatic front camera switching. Options for 5, 7, 9 or 11 seconds are user-selectable for the length of time the front camera input stays active once the vehicle is placed out of reverse.

If the user wants only an AUX video input **without front camera**, set **AV1-SEL** to **ON**

Once finished with settings, place DIP SWITCH 1 back into the **UP position** and reset power to interface.

- Once all connections are made and dip switches are set properly, placing the vehicle in reverse will display the connected camera with dynamic guidelines for convenience.
- Additionally, see below for AUX/Front camera activation using factory buttons.

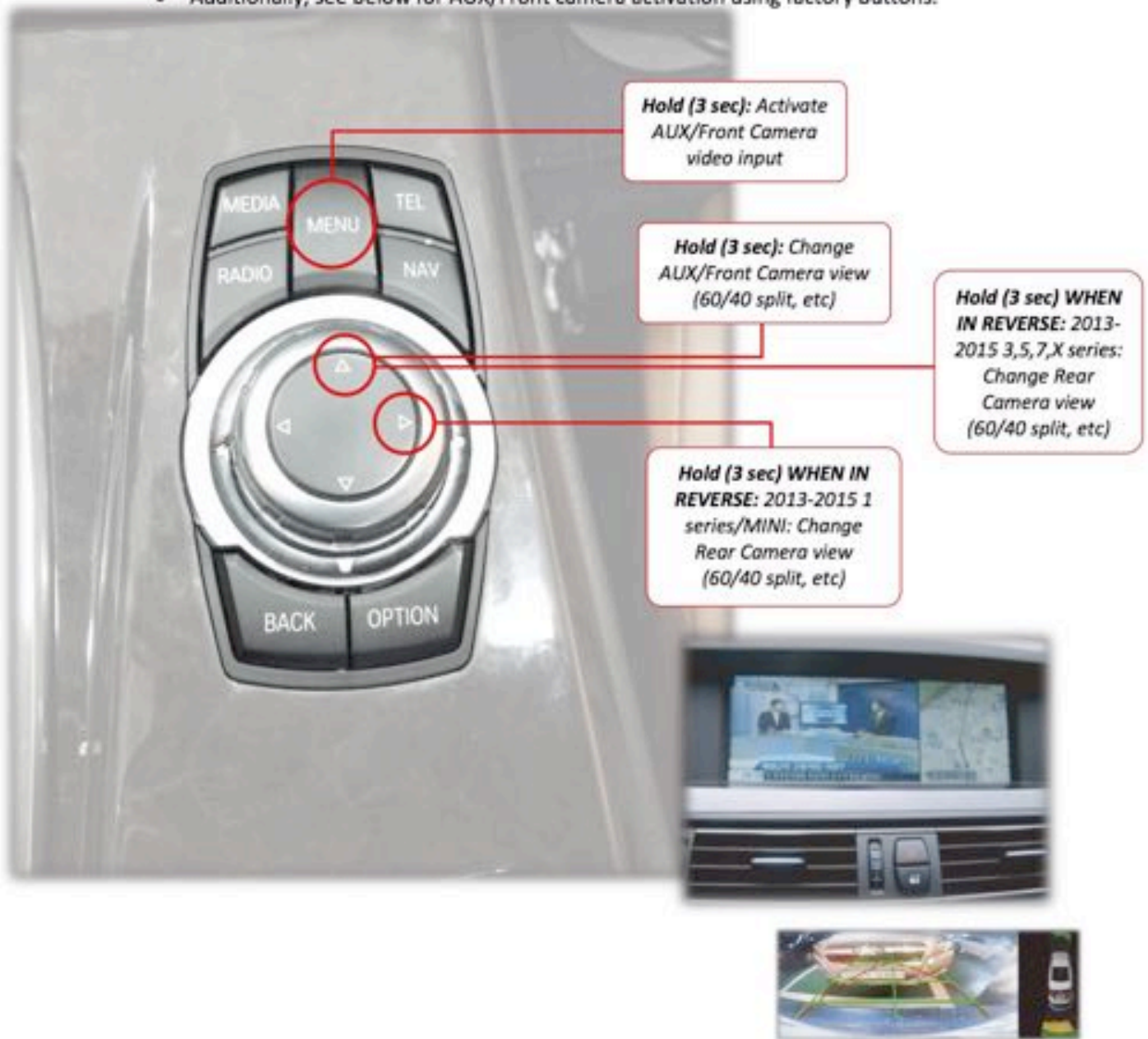

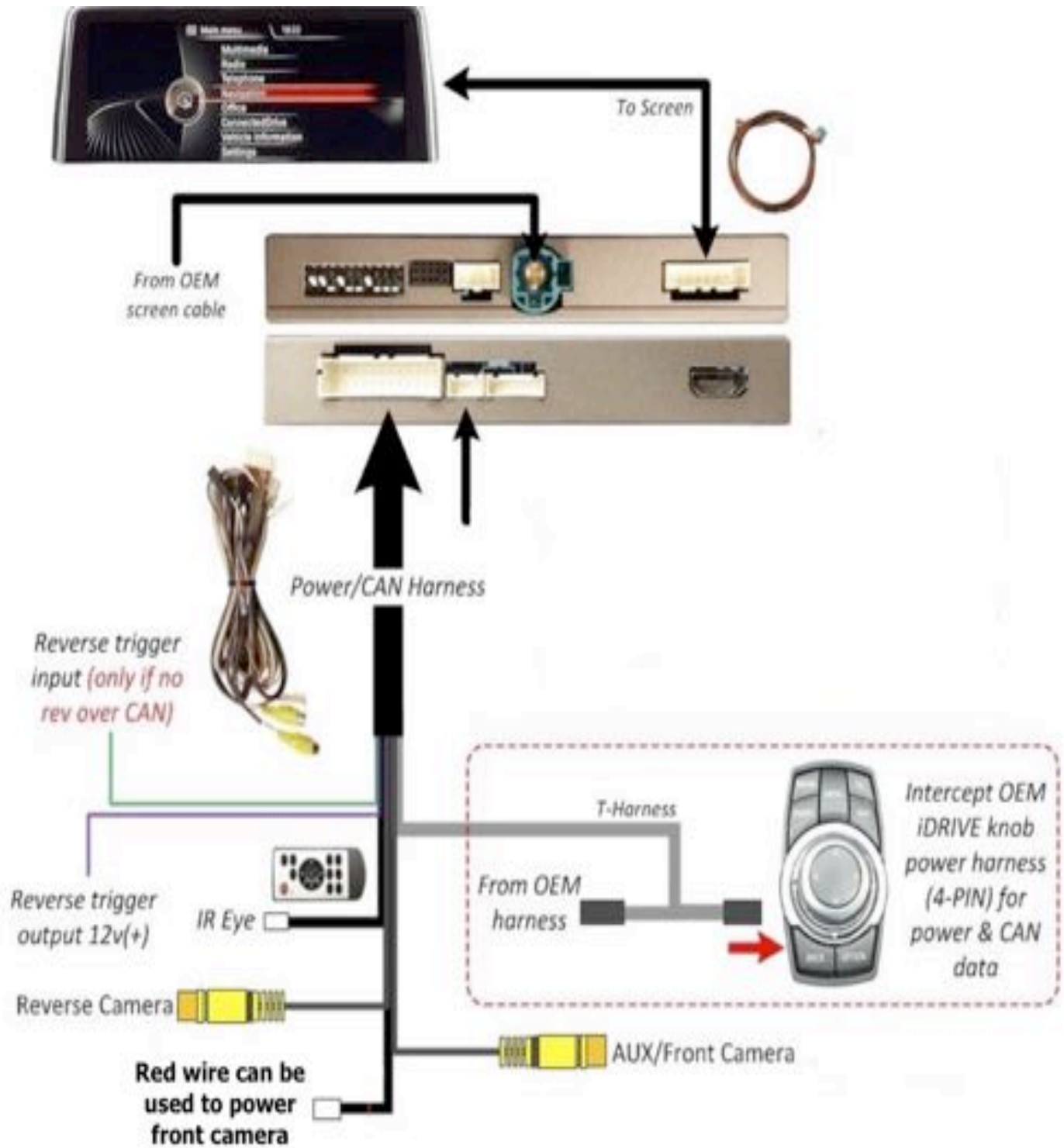

Dip SW:	1	2	3	4	5	6	7	8	9	10
UP	KEEP UP	SKIPS V1	SKIPS V2	RVC OFF	N/A	CAN SETTING	CAN SETTING	HIGH RES	VEH SETTING	KEEP DOWN
DOWN	KEEP UP	ENABLES V1	ENABLES V2	RVC ON	N/A	CAN SETTING	CAN SETTING	LOW RES	VEH SETTING	KEEP DOWN



2013: 1 & 3 series
8.8" screen



2014: 1 series
6.5" screen



2014+: 3, 5, 7 series
10.2" screen



2014: MINI
8.8" screen



2015: MINI
6.5" screen



2015: X-series
8.8", 10.2" screen



***Note: after adjusting Dip Switches, you must disconnect and reconnect power to the interface or the change will not be implemented.**



2013+: X-3 & 3-series
6.5" screen