

Rear Vision System – NAV Display 2009-Current Chevrolet Silverado, Silverado HD; GMC Sierra, Sierra HD (Kit part number 9002-9501)

**Please read thoroughly before starting installation
and check that kit contents are complete.**

Kit Contents:

- Camera/Module/Bezel Assembly
- Chassis Harness
- NAV Harness
- 1 bag containing:
 - 30 Wire Ties
 - 1 Ground Nut
 - Anti-Corrosion Coating (in a white bottle)
 - Lock Plug (optional)
 - Gray/Blue Wire with terminal for older vehicles (optional)
 - Gray/Orange Wire with terminal for older vehicles (optional)
- 1 bag containing:
 - Jumper Harness
- 1 bag containing:
 - Template (along with these instructions)

Tools Required:

- Socket Wrench
- 7mm, 10mm, & 13mm Sockets
- Torque Wrench
- Phillips & Flat Blade Screwdrivers
- Delphi Terminal Tool 12094429 or a small flat blade watch repair screw driver
- Power Drill
- 25.4mm (1") Hole Saw
- 29mm (1-1/8") Hole Saw
- Deburring Tool
- Plastic Trim Removal Tool
- Center Punch
- Vehicle Hoist

**NOTE: We strive to provide accurate and up-to-date installation instructions.
For the latest full color instructions, as well as an installation video,
please visit www.brandmotion.com.**

Preparation

1. Ensure all lamps and accessories are OFF.
2. Ensure the ignition switch is in the OFF position.
3. Loosen the negative battery cable bolt. Remove negative battery cable from terminal and position away from battery.
4. Wait one (1) minute prior to working on the vehicle to assure SIR roof rail airbag system has been disabled for your safety.

Install Camera Bezel into Tailgate

5. Lower Tailgate and remove center bezel mounting bolt (1), using 13mm socket. Figure 1.

FIGURE 1

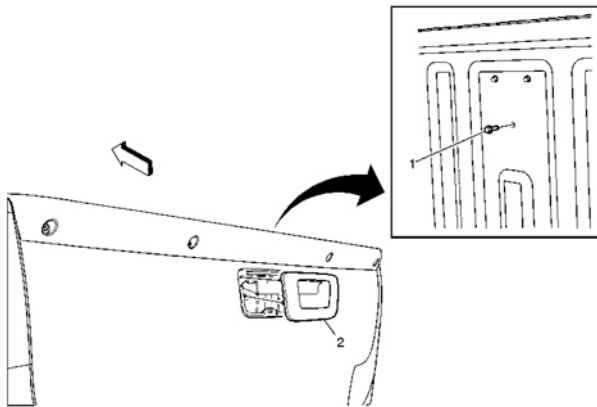

6. Release, by hand, the three retainer clips securing the bezel (2) to the Tailgate outer panel. Lift the Tailgate latch handle in order to aid in the removal of the latch handle bezel. Figure 1.
7. If the Truck is not equipped with Tailgate Lock (&A60), remove the two upper Tailgate Latch Handle Bolts (1) from the Tailgate Latch Handle (2), using 13mm socket. Figure 2. Release Rods before removing (inset). If equipped, skip this step.

FIGURE 2

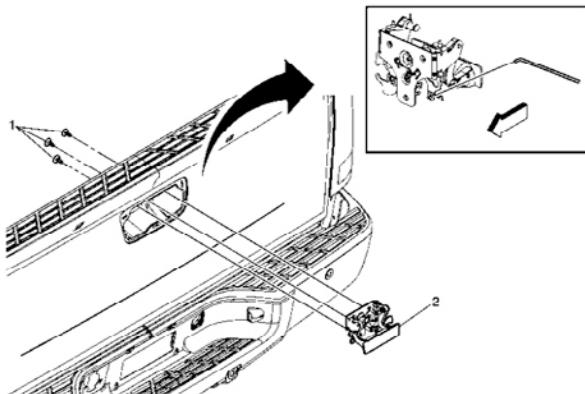

INSTALLATION INSTRUCTIONS

8. Prepare a work surface for the Tailgate, as it will be removed.
9. Disconnect the two Tailgate support cables. Figure 3.

FIGURE 3

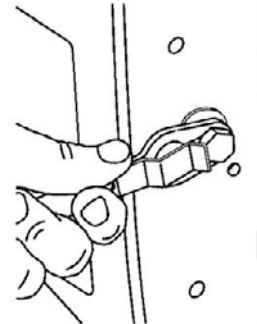

10. With the aid of an assistant, remove the Tailgate and locate to clean work surface. Figure 4.

FIGURE 4

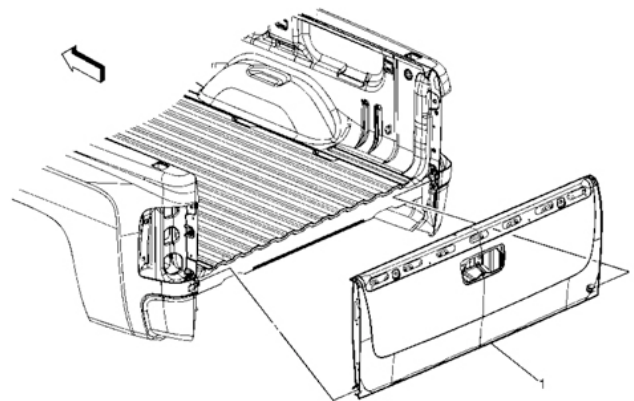

11. Locate the supplied Template Sheet for the Tailgate and Pickup Box Sill.
Note: For Model Year 2009 and forward, some vehicles may already have a flanged hole in the pickup box sill. If this is the case, remove the flange from the front side of the sill and skip steps 13 and 15.
12. Cut out Tailgate Template and attach to Tailgate using tape. Using a Center Punch, mark the center of hole.
13. Cut out Sill Plate Template and attach to Pickup Box Sill using tape. Using a Center Punch, mark the center of hole.
14. Using a power drill and a 29mm (1-1/8") Hole Saw, cut out the harness pass-through in the Tailgate. Figure 5.

FIGURE 5

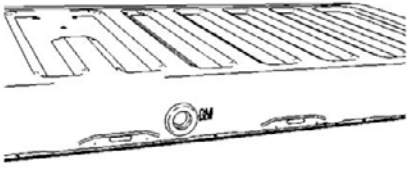

15. Using a power drill and a 29mm (1-1/8") Hole Saw, cut out the harness pass-through in the Pickup Box Sill. Figure 6.

FIGURE 6

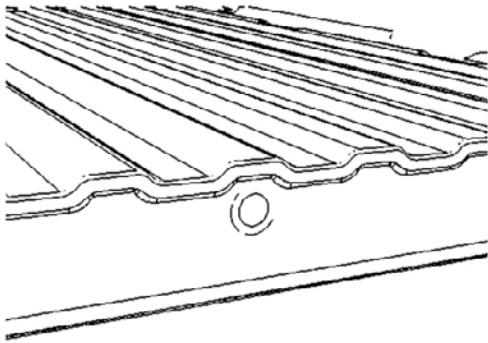

16. Clean rough edges using a Deburring Tool.
17. Apply supplied Anti-Corrosion Coating to the two cut outs.
18. Locate the supplied Camera Bezel Assembly. Figure 7.

FIGURE 7



19. If the Truck is equipped with a factory Tailgate Lock, remove the lock cylinder from the original Tailgate Bezel. Remove the Tailgate Lock Cylinder Retaining Clip (1) and then the Tailgate Lock Cylinder (2). Figure 8.

INSTALLATION INSTRUCTIONS

FIGURE 8

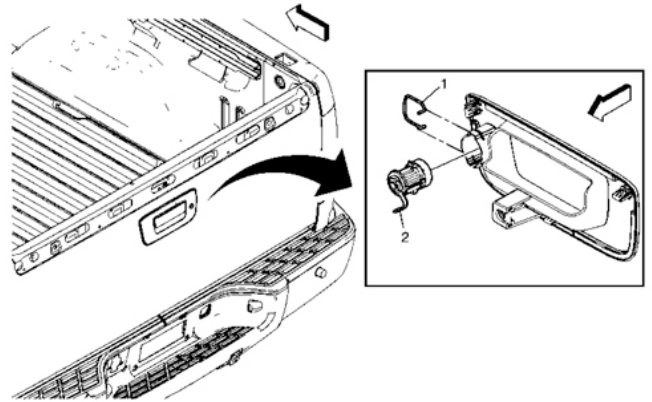

20. If equipped, insert the Tailgate Lock Cylinder (2) into the new Tailgate Bezel and re-attach the Tailgate Lock Cylinder Retaining Clip (1). Figure 8.
a. If the Truck is not equipped with factory Tailgate Lock, install supplied Lock Plug.
b. If locking features are desired, a Tailgate Latch Handle (part number 25775280) and a Tailgate Lock Cylinder (part number 25775278) are available through GM dealers.
21. Install the new Tailgate Bezel Assembly, by first routing the Camera Assembly harness pigtail through the Tailgate Bezel opening down through the Tailgate to the 29mm hole at the bottom of the Tailgate. Figure 9.

FIGURE 9

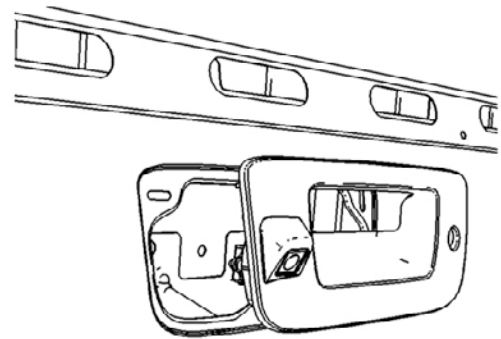

22. Pull connector (2), first grommet (3), and second grommet (4) through new Tailgate (1) pass-through. Figure 10.

FIGURE 10

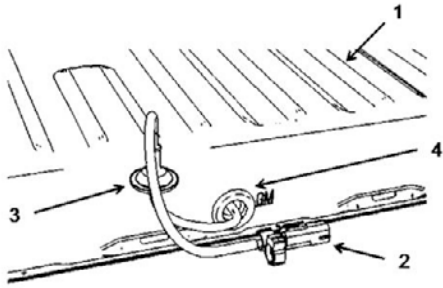

23. Snap the Tailgate Bezel Assembly into the Tailgate.
24. Seat the second grommet (4) securely around opening. Figure 10.
25. Install remaining Tailgate Latch Handle Bolt in Tailgate and tighten all three 13mm bolts to 25 N·m (18 lb ft).
26. If present, remove the Rear License Plate.
27. With the help of an Assistant, re-install the Tailgate onto the Pickup Box, carefully routing the Camera harness through the opening on the Pickup Box Sill.
28. Re-attach Tailgate Support Cables and close Tailgate. Figure 11.

FIGURE 11

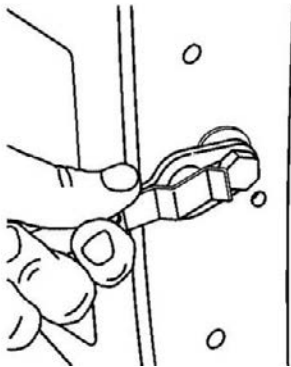

29. Through the License Plate Opening pull the Camera Assembly Harness (2) until the first grommet (3) is properly seated in the Pickup Box Sill (1). Figure 12.

FIGURE 12

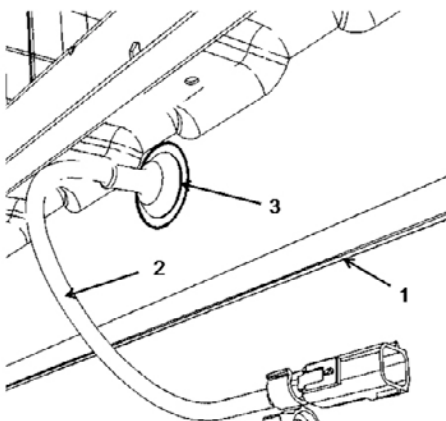

INSTALLATION INSTRUCTIONS

Cut Accessory Pass-Through in Front of Dash

30. Using a Trim Removal Tool, remove Left Instrument Panel Outer Trim Cover (1). Figure 13.

FIGURE 13

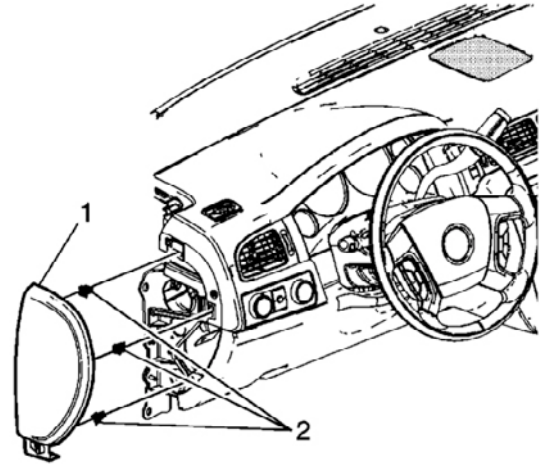

31. Remove the Parking Brake Release Handle Bolt and then the Handle. Remove the two Knee Bolster Assembly Screws (1) and the Knee Bolster Assembly (2). Figure 14.

FIGURE 14

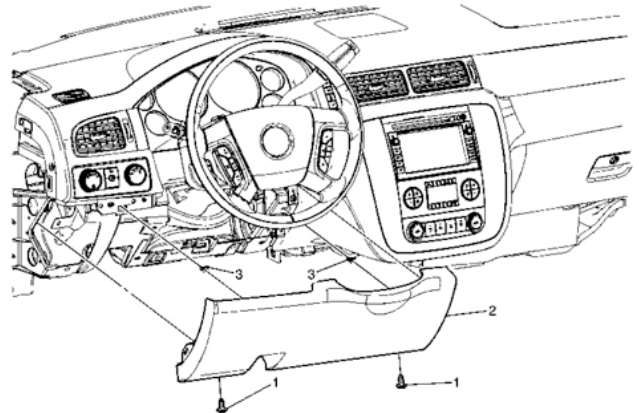

32. Disconnect the electrical connections, if applicable.
33. Remove the M-BEC cover.
34. Disengage the M-BEC (1) from support bracket. Figure 15.

FIGURE 15

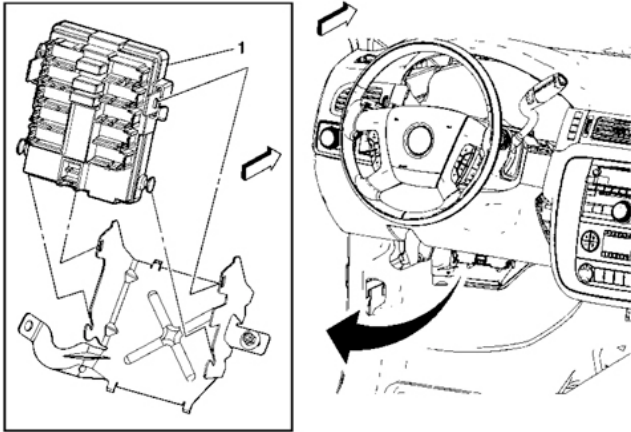

- 35. Relocate M-BEC up into the IP to gain access to Front-of-Dash Matte Opening behind M-BEC.
- 36. Locate cut-out in dash matte. Locate the dimple in the sheet metal and then use a center punch to help start a drill bit as close as possible to dimple. Using a power drill and a 25.4mm (1") hole saw, drill out the chassis harness pass-through (2). Figure 16.

FIGURE 16

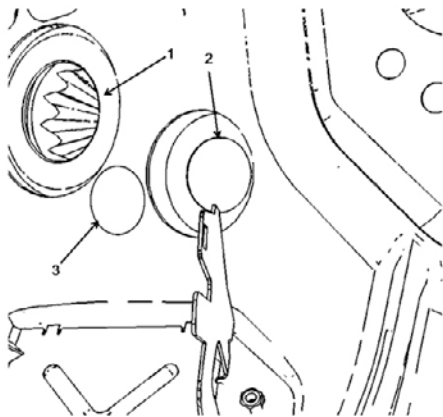

- 37. If this location is occupied by Trailer Brakes (&JL1) or another Accessory, drill a new Chassis Harness pass-through (3) between the IP Harness (1) and Trailer Brake (2) pass-through grommets. Figure 16.
- 38. Clean rough edges using a Deburring Tool. Figure 16.
- 39. Apply Anti-Corrosion Coating to the opening. Figure 16.

INSTALLATION INSTRUCTIONS

Install NAV Harness

- 40. Remove the NAV radio trim bezel by inserting plastic trim removal tool along edges and twisting retaining clips. Figure 17.

FIGURE 17



- 41. Remove fasteners retaining accessory and HVAC control head using 7mm socket. Figure 18.

FIGURE 18

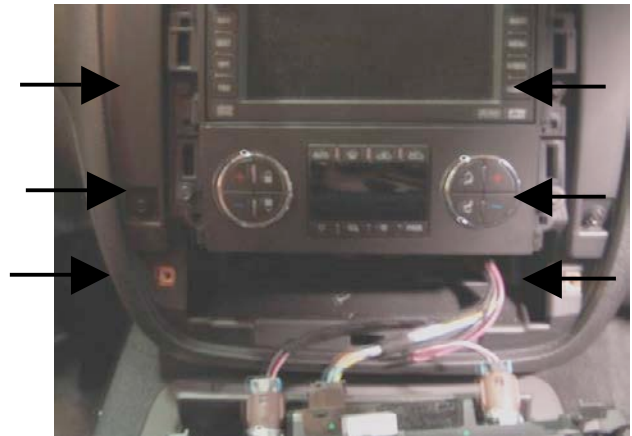

- 42. Remove fasteners retaining radio control head using a 7mm socket. Once fasteners are removed, lower the radio and unplug brown connector. Figures 19 and 20.

FIGURE 19



FIGURE 20

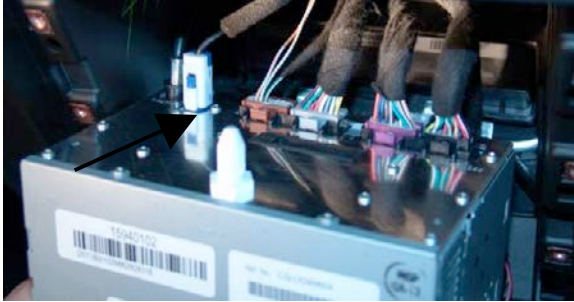

- 43. Locate the supplied NAV Harness.
- 44. Remove red terminal retaining plug (GM service part number 13579578) from the brown radio connector. Figure 21. Insert gray with blue stripe wire terminal into cavity 6 and gray with orange stripe wire terminal into cavity 7 (see Figure 21A). NOTE: Some older vehicles may require round terminals. In these cases, splice the provided 3" gray with blue stripe wire to the NAV Harness gray with blue stripe wire and splice the provided 3" gray with orange strip wire to the NAV Harness gray with orange stripe wire before inserting into cavities 6 and 7. Note: If wires exist in these cavities, remove and isolate with electrical tape.

FIGURE 21



FIGURE 21A

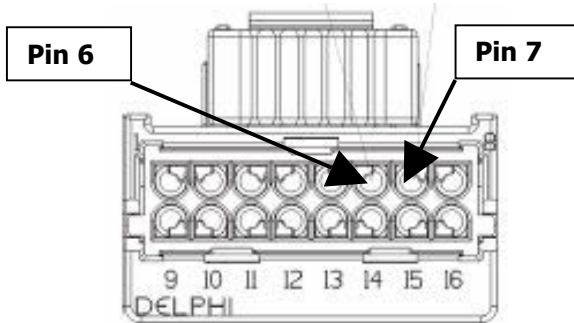

INSTALLATION INSTRUCTIONS

- 45. Reinstall red terminal retaining tab into connector and reinsert connector into radio.
- 46. Route the NAV radio harness through the opening and down to the M-BEC. Secure the NAV harness to the knee bolster support with supplied Wire Ties. Figure 22.

FIGURE 22



- 47. Reinstall the radio, HVAC control head, and the accessory panel using a 7mm socket. Tighten all fasteners to 2.0 N·m (18 lb in). Figure 23.

FIGURE 23



- 48. Reinstall radio/accessory trim bezel. Assure that all clips are fully seated and that bezel sits flush with dash panel. Figure 24.

FIGURE 24



49. Remove C12 Connector (Brown) from the M-BEC.
Figure 25.

FIGURE 25

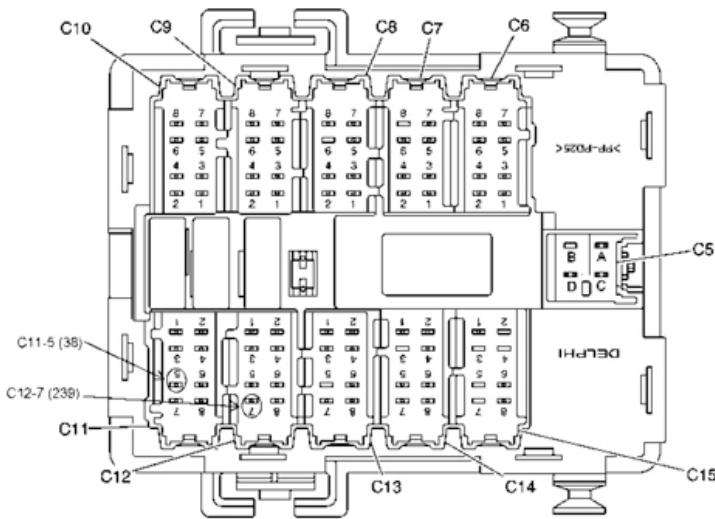

50. Remove the TPA from the C12 Connector. Figure 26.
51. Connect the pink wire from the supplied NAV Harness to C12 Cavity 7. Figure 26. **NOTE:** Pickups with cooled seats require a Denali Jumper Harness, Brandmotion kit number 9002-6005, available separately.

FIGURE 26

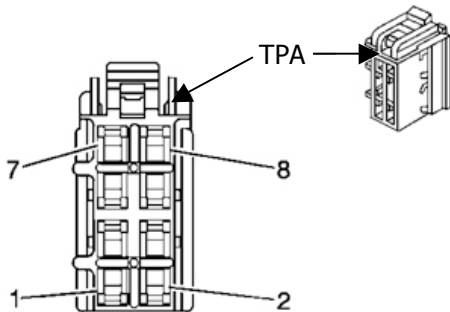

52. Re-insert TPA and C12 Connector into M-BEC. Figure 25.
53. Remove the C11 Connector (Gray) from the M-BEC. Figure 25.
54. Remove the TPA from the C11 Connector. Figure 26.
55. **For model years 2007 thru 2009 and 2010, if blue wire does not exist in C11 Cavity 5**

- Snap the supplied Jumper Harness into black connector on the supplied NAV Harness. Figure 27.

INSTALLATION INSTRUCTIONS

FIGURE 27

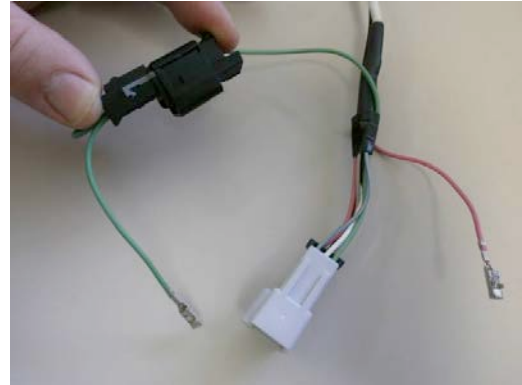

- Connect the green wire of the Jumper Harness to cavity 5 of C11. Figure 26. Proceed to Step 56.

For 2010, if blue wire exists in C11 Cavity 5:

- Unlock the black connector of the NAV Harness. Use Delphi Terminal Tool 12094429 or a small flat blade watch repair screw driver to completely press out the gray TPA device. Figure 28.

FIGURE 28

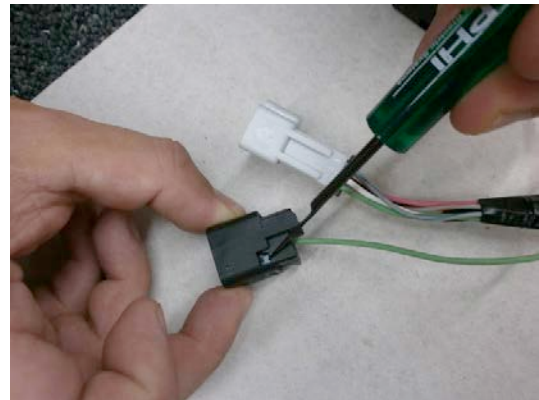

- Remove the blue wire from cavity 5 of the C11 connector.
- Insert blue wire into the other cavity of the black connector on the supplied NAV Harness. Figure 29.

FIGURE 29

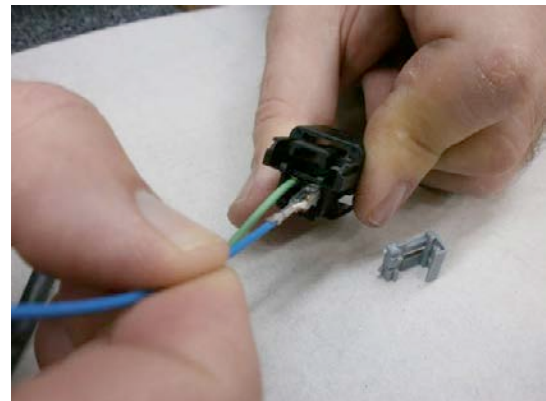

- Use Delphi Terminal Tool 12094429 or a small flat blade screwdriver to press the terminal of the blue wire into the connector. NOTE: the terminal fits tightly initially, and when it goes into the slot it often slides in too far. If this occurs, the terminal must be backed up to sit flush with the terminal from the green wire. Figure 30.

FIGURE 30

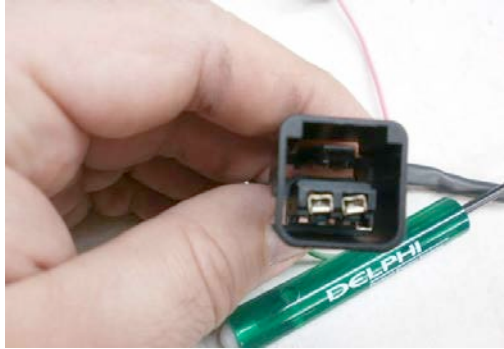

- Slide gray TPA inside the black connector to lock green and blue wires into place.
 - Snap the supplied Jumper Harness into black connector on the supplied NAV Harness. Figure 27. Then, connect the green wire of the Jumper Harness to cavity 5 of the C11 connector (where blue wire was removed).
56. Re-insert TPA and C11 Connector into M-BEC. Figure 25.
 57. Locate the Ground ring terminal on the black wire of the NAV Harness and attach at lower fastener of knee bolster support, using the supplied Ground Nut and a 10mm socket. Tighten to 4 N·m (36 lb in). Figure 31.

FIGURE 31

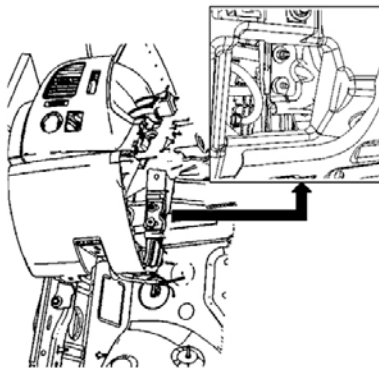

Install Chassis Harness

58. Locate the supplied Chassis Harness.
59. Route the grommet-end of the Chassis Harness through the Driver's Side Wheel Housing and then through the opening in the Front of Dash. Figure 32.

INSTALLATION INSTRUCTIONS

FIGURE 32

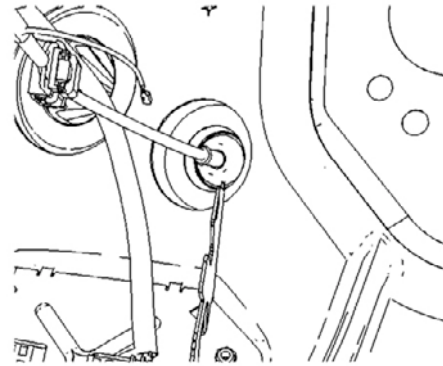

60. From the inside of the cab, pull the Chassis Harness through until the grommet is properly seated.
61. Remove the green lock tab from the Chassis Harness front connector by inserting the tip of Delphi Terminal Tool 12094429 or a small flat blade screw driver between the lock tab and connector and prying the tab out. (Figure 33)

FIGURE 33

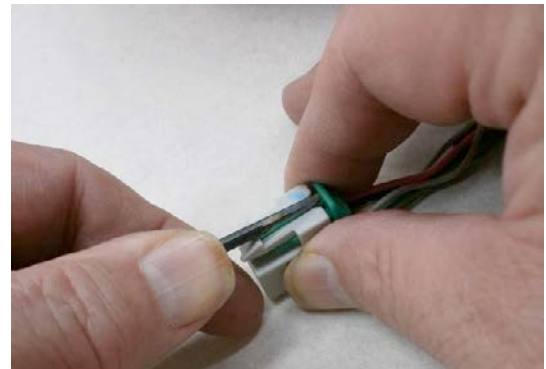

62. Connect the Chassis harness to the NAV Harness then reinstall the green lock tab. Secure both harnesses to vehicle wiring with supplied Wire Ties. Figure 34.

FIGURE 34



63. Install the MBEC into Support Bracket. Figure 35.

FIGURE 35

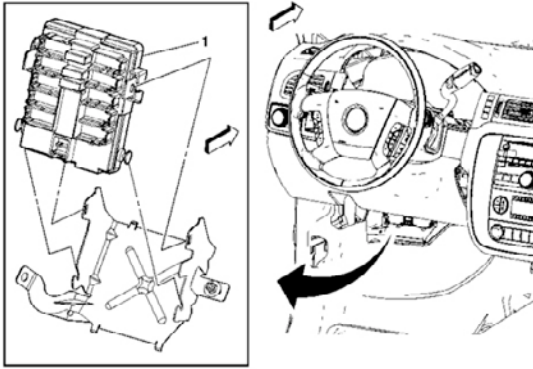

64. Install the MBEC cover onto the MBEC.
65. Raise vehicle on hoist to route the Chassis Harness.
66. Route the supplied Chassis Harness, working towards the rear of the vehicle, along the existing Chassis Harness, routing away from Body Mounts.
67. Connect the supplied Chassis Harness to the Camera Assembly Harness.
68. Secure the supplied Chassis Harness along the existing Chassis Harness using Wire Ties every 200mm (approximately 8"). Note: Depending on the vehicle wheelbase there may be excess length in the Chassis Harness. Loop, and secure with supplied Wire Ties any excess harness length along the Body Frame away from Mechanical areas.
69. Lower the truck.
70. Re-Install Rear License Plate, if necessary.

INSTALLATION INSTRUCTIONS

71. Connect the negative battery terminal. Tighten the negative cable nut to 5 N·m (44 lb in).
72. System requires a GM dealer or authorized installer, using a tech 2, to reprogram the NAV radio to accept video display (reference GM part number 25836479).
73. Test system functionality.
74. Re-install the Knee Bolster Assembly. Tighten Screws to 2 N·m (18 lb in). Re-install Parking Brake Release Handle and Bolt, tighten to 9 N·m (80 lb in). Figure 37.

FIGURE 37

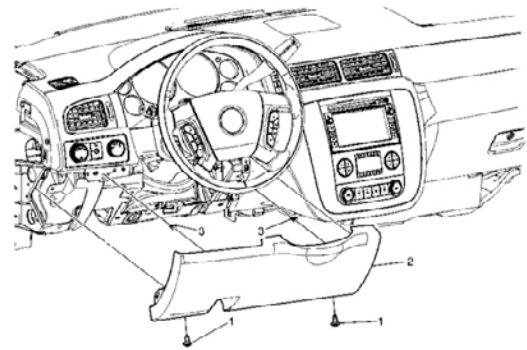

75. Re-install Instrument Panel Outer Trim Cover. See Figure 13.