

**2009 – Current Ram Truck Qi Wireless Charging Kit  
(Kit # FDMC-1260)**

Please read thoroughly before starting installation and check that kit contents are complete.

**Items Included in the Kit:**

Qi Wireless Charging Module with  
Ram Specific Substrate and Mat  
Power Harness with 3 amp Fuse  
2 – Flat Head Torx 1" Screws  
These Instructions with Template  
Removable Consumer Product Label

**Tools & Supplies Needed:**

Plastic Trim Removal Tool  
T-10 Torx Driver  
Phillips Screwdriver  
Center Punch/Scribe Tool  
Power Drill  
1/8" and 1/2" Drill Bits  
Soldering Iron & Solder (Recommended)  
Tape or Heat Shrink Electrical Tubing

**\*Note this product is designed to work with Qi compatible devices. Please confirm that your device is Qi compatible before installation. Visit [www.brandmotion.com](http://www.brandmotion.com) for phone compatibility guide.**

**Safety Precautions:**

- Work in well ventilated area that is clear of obstructions.
- Secure vehicle with tire chucks in both front and rear of tires.
- Turn vehicle accessories OFF and ensure ignition key is in OFF position.
- Wear safety goggles and snug fitting clothes.
- Use tools only for their intended purpose and which are in good repair.
- Only perform this task if confidence, skill, and physical ability permit.

**NOTE: We strive to provide accurate and up-to-date installation instructions.**

**IMPORTANT: Do not place smart keys within 6 inches of charging mat. Vehicle may not detect key to start vehicle. Do not place metal objects in tray while charging.**

## INSTALLATION INSTRUCTIONS

**Step 1: Remove rubber tray liner from front storage tray.**



**Step 2: Use a Phillips Screwdriver to remove (2) Phillips screws.**



**Step 3: Use a Plastic Trim Removal Tool to remove chrome surround trim. (**DO NOT REMOVE THE CHROME TRIM RING ON 2016 AND UP TRUCKS, THIS TRIM DOESN'T REMOVE.**)**



**Step 4: Use a Plastic Trim Removal Tool to remove upper console trim.**



**Step 5: Cut out provided template and mark location for 1/2" hole.**

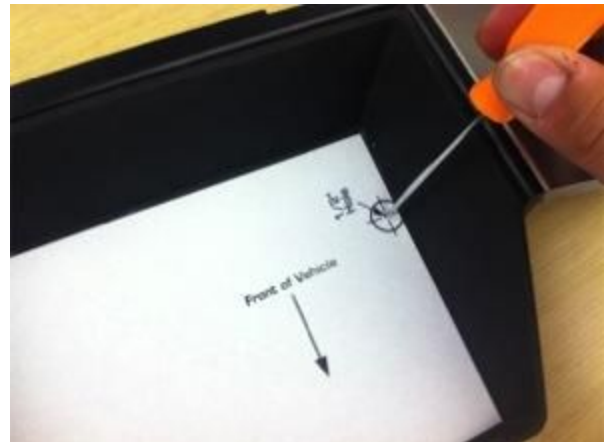

## INSTALLATION INSTRUCTIONS

**Step 6: Drill 1/2" hole through rubber mat and upper console trim.**



**Step 7: Disconnect power point plug from vehicles console.**



**Step 9: Route black connector of Charging Module through 1/2" hole of rubber tray liner.**



**Step 8: Splice Red wire of Power Harness to the Red/Yellow (12v ignition) wire of the power point plug and Splice Black wire of Power Harness to the Black (ground) wire of the power point plug**

**RECOMMENDED:** Solder wires and cover with Heat Shrink Tubing.

**Step 10: Route black connector of Power Harness through 1/2" in upper console trim.**

## INSTALLATION INSTRUCTIONS



**Step 11: Connect Power Harness to Charging Module.**



**Step 12: Place Freedom Charge Module and rubber tray liner into upper console trim. Make sure to fully snap in rubber liners**



**Step 13: Using a center punch/scribe tool mark the location of the (2) chamfered holes through Charging Module onto rubber tray liner.**

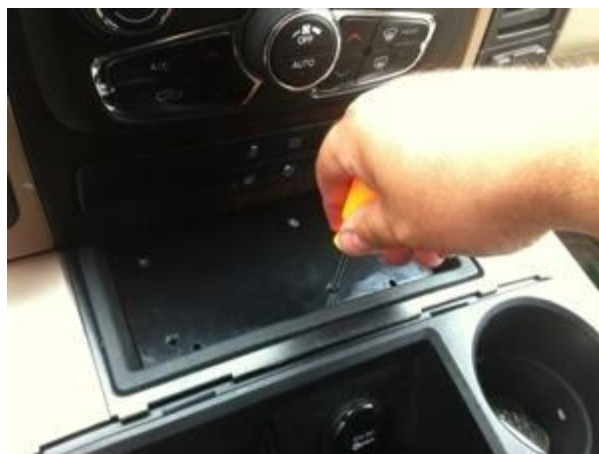

**Step 14: Swing Charging Module away and Drill (2) 1/8" holes through rubber tray liner and upper console trim.**



**Step 15: Insert the (2) 1" Flat Head T-10 Torx Screws through Charging Module and rubber tray liner into upper console tray.**

## INSTALLATION INSTRUCTIONS



**Step 16: Install Non-Slip Freedom Charge Mat to Wireless Charging Module.** Place the 4 locator pins in corresponding holes.



**Step 17: Test system. LED light will illuminate Blue once accessories are on. Once Qi equipped device is placed on Freedom Charge LED will illuminate Green and charging begins.** \*Please note on some devices syncing may take up to 15 seconds. Coil locations vary on various devices; move device on mat until LED illuminates green.

**Step 18: Reassemble vehicle.** Follow your disassembly steps in reverse order, taking care not to bind the harness wiring when reinstalling trim.

**Step 19: Place removable consumer product label on center of mat.**

